

Bylaw 016-2025 Schedule "A"

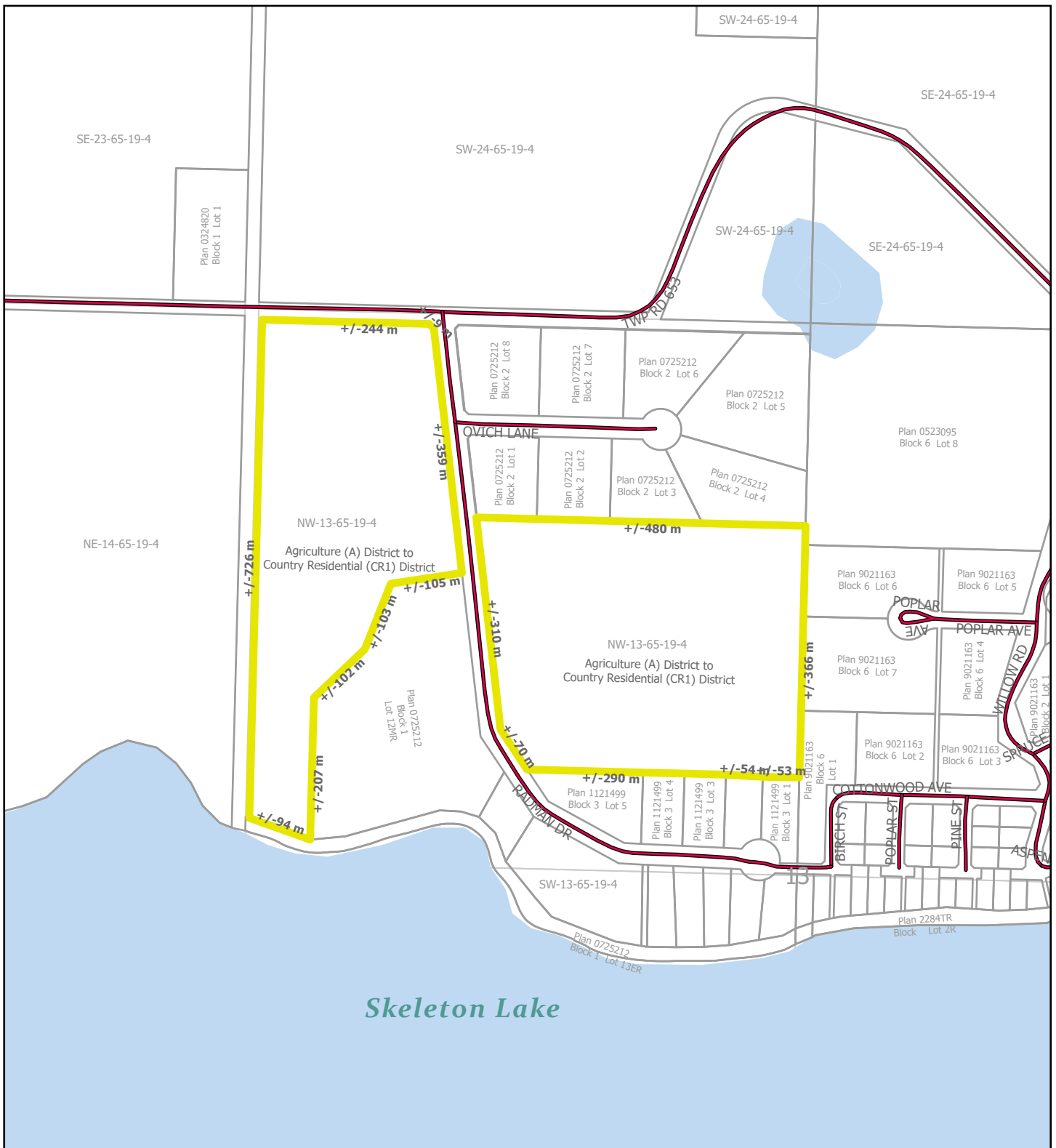

Skeleton Lake

Athabasca County
Alberta



Drawn : 2025-06-03

PLAN SHOWING:

File Number: 016-2025 NW 13-65-19 W4M
Lot Rezoning: Agriculture (A) District to Country Residential (CR1) District

Athabasca County makes no representation or warranties regarding the information contained in this document, including without limitation, whether said information is accurate or complete. Persons using this document do so solely at their own risk, and Athabasca County shall have no liability to such person for any loss or damage whatsoever. This document shall not be copied or distributed to any person without the express written consent of Athabasca County, Copyright Athabasca County. All rights Reserved.

N



1:8,000

